

I-90, Exit 28

For sale or land lease

\$445,000

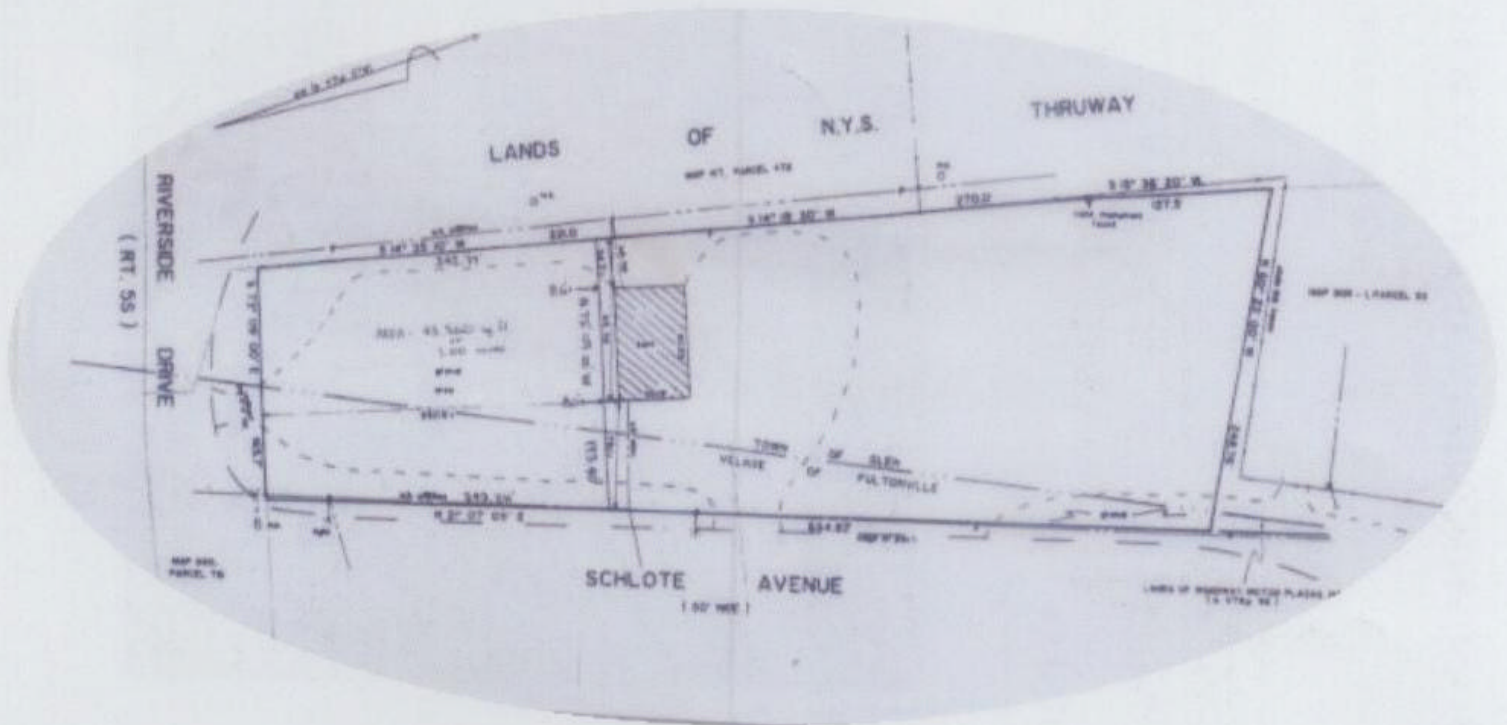

- 3.3 acres, Fonda/Fultonville, NY
- I-90 NYS Thruway Exit 28 ramp frontage
- 6,500 ± cars per day
- Water, sewer, gas available
- Major trucking distribution exit for WalMart and Target
- Tourist exit for popular Sacandaga Lake area and business in Montgomery, Fultonville, and Saratoga counties
- Great location for fast food, motel, restaurant, service business
- Zoned commercial
- Will subdivide
- Empire Zone